

AREA MAP

NO SCALE

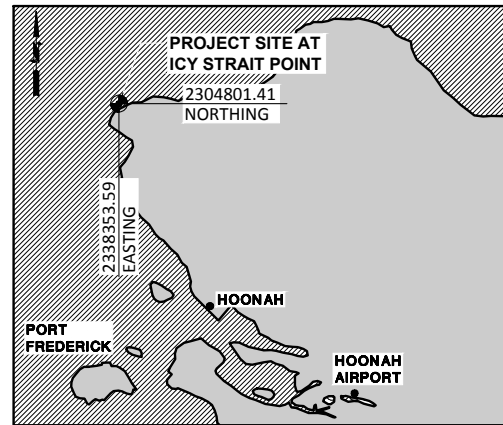

VICINITY MAP

NO SCALE

### NOTES:

1. PROJECT VERTICAL DATUM IS MLLW AT 0.00 FEET. THE MEAN HIGHER HIGH WATER LINE (MHHW) HAS BEEN DETERMINED TO BE AT ELEVATION 14.80 FEET. THE HIGH TIDE LINE (HTL) HAS BEEN DETERMINED TO BE AT ELEVATION 19.30 FEET, PER THE CORPS DEFINITION.
2. PROJECT HORIZONTAL DATUM IS ALASKA STATE PLANE, NAD83, ZONE 5001, US SURVEY FOOT (GROUND) PROJECTION. FOR REFERENCE, A PROJECT MONUMENT IS ALSO DESCRIBED IN THE WGS84 PROJECTION (ESTABLISHED 1984, REVISED 2004).
3. DIRECTIONS TO SITE. FROM THE HOONAH, AK AIRPORT, TURN LEFT ONTO AIRPORT ROAD AND CONTINUE ON FRONT STREET AND CANNERY ROAD UNTIL IT DEAD ENDS AT ICY STRAIT POINT. FROM THE HOONAH, AK SEAPLANE BASE, HEAD NORTHWEST ON FRONT STREET AND CONTINUE ONTO CANNERY ROAD UNTIL IT DEAD ENDS AT ICY STRAIT POINT.

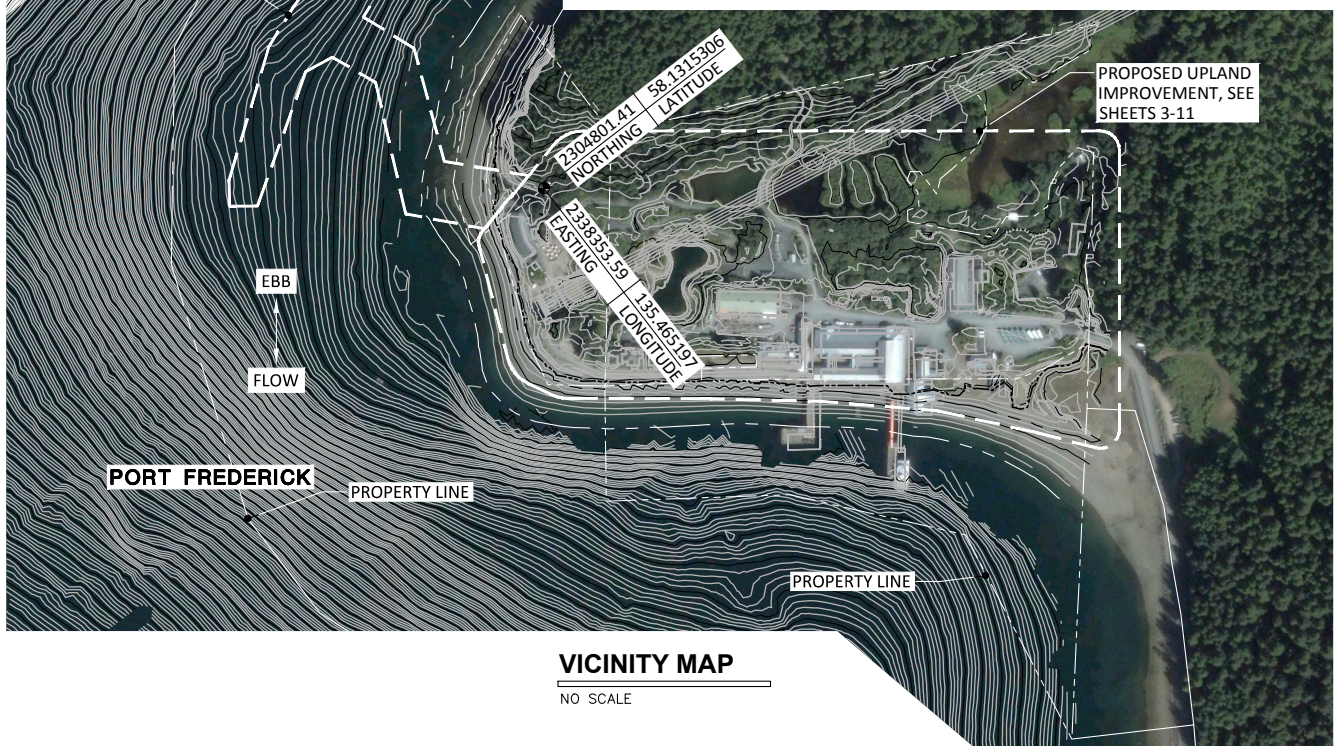
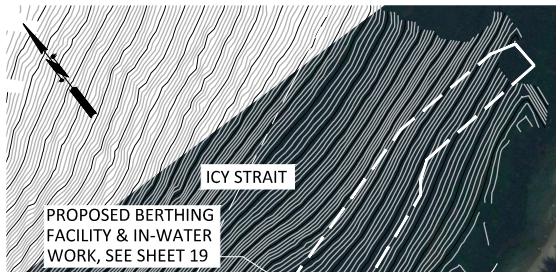

VICINITY MAP

NO SCALE

### PROJECT LOCATION

#### PROPOSED PROJECT:

Proposed Hoonah Berthing Facility and Upland Improvements. Includes in-water and upland construction, upland demolition, and other activities.

#### ADJACENT PROPERTY OWNERS:

- 1) US Forest Service (Tongass)
- 2) City of Hoonah
- 3) Alaska Department of Natural Resources

#### USACE REFERENCE NO: NWS-POA-2012-0404

APPLICANT: Huna Totem Corporation

LOCATION: 108 Cannery Road, Hoonah, Alaska 99829

LAT/LONG: 58.1315306 / 135.465197

IN: Icy Strait & Port Frederick

NEAR: Hoonah, AK (1.5 miles NW)

COUNTY: Hoonah Angoon Borough

STATE: AK

Sheet 1 OF 24

Date: 8/4/14

## EXISTING FACILITY LEGEND:

|  |  |  |                       |
|--|--|--|-----------------------|
|  | B.L.M. MONUMENT (RECOVERED)              |  | DITCH                 |
|  | 7570-S SECONDARY MONUMENT (ESTABLISHED)  |  | EDGE OF GRAVEL        |
|  | PRIMARY MONUMENT BY OTHERS (RECOVERED)   |  | EDGE OF TRAIL         |
|  | SECONDARY MONUMENT BY OTHERS (RECOVERED) |  | TOE OF SLOPE          |
|  | TEMPORARY BENCH MARK (T.B.M.)            |  | EDGE OF WATER         |
|  | SANITARY SEWER MANHOLE                   |  | WOOD FENCE            |
|  | SANITARY SEWER CLEAN-OUT                 |  | MAJOR CONTOUR LINE    |
|  | HYDRANT                                  |  | MINOR CONTOUR LINE    |
|  | WATER VALVE                              |  | BRUSH LINE            |
|  | POWER POLE                               |  | LANDSCAPED VEGETATION |
|  | GUY ANCHOR                               |  | ROCK WALL             |
|  | POWER VAULT                              |  | PROPERTY LINE         |
|  | TRANSFORMER                              |  | TOP OF BANK           |
|  | LIGHT                                    |  | LOG BARRIER/WALL      |
|  | ELECTRIC PEDESTAL                        |  | WOOD AND WIRE RAILING |
|  | TELEPHONE RISER OR JUNCTION              |  | WETLAND BOUNDARY      |
|  | JUNCTION BOX                             |  | EXISTING WETLAND AREA |
|  | STREET SIGN                              |  | STRUCTURE/BUILDING    |
|  | WATER VALVE                              |  | EXISTING GRAVEL       |
|  | HOSE BIB                                 |  |                       |
|  | FIRE HYDRANT                             |  |                       |
|  | SATELLITE DISH                           |  |                       |
|  | WETLANDS FLAGGING                        |  |                       |
|  | SIGN                                     |  |                       |
|  | TEST PIT                                 |  |                       |

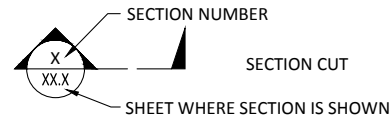

## PROPOSED FACILITY LEGEND:

|  |                       |
|--|-----------------------|
|  | DITCH CENTER LINE     |
|  | RELOCATED LOG BARRIER |
|  | WOOD FENCE            |
|  | FILL DAYLIGHT LINE    |
|  | CUT DAYLIGHT LINE     |
|  | MAJOR CONTOUR LINE    |
|  | MINOR CONTOUR LINE    |
|  | CSP CULVERT           |
|  | CULVERT END SECTION   |
|  | GRAVEL SURFACE        |
|  | BOARDWALK             |

|  |                      |
|--|----------------------|
|  | WETLAND IMPACT AREAS |
|  | HAND PLACED RIPRAP   |

## TESC LEGEND:

(TEMPORARY EROSION AND SEDIMENT CONTROL)

|  |  |
|--|--|
|  | REMOVE AND REPLACE   |
|  | CLEARING AND GRUBBING LIMITS                                   |
|  | REMOVAL OF STRUCTURES AND OBSTRUCTIONS                         |
|  | SLIT FENCE   |
|  | REMOVE AND RELOCATE EXISTING AGGREGATE BASE AND SURFACE COURSE |
|  | CLEARING AND GRUBBING  |

### PROPOSED PROJECT:

Proposed Hoonah Berthing Facility and Upland Improvements. Includes in-water and upland construction, upland demolition, and other activities.

### ADJACENT PROPERTY OWNERS:

- 1) US Forest Service (Tongass)
- 2) City of Hoonah
- 3) Alaska Department of Natural Resources

USACE REFERENCE NO: NWS-POA-2012-0404

APPLICANT: Huna Totem Corporation

LOCATION: 108 Cannery Road, Hoonah, Alaska 99829

LAT/LONG: 58.1315306 / 135.465197

IN: Icy Strait & Port Frederick

NEAR: Hoonah, AK (1.5 miles NW)

COUNTY: Hoonah Angoon Borough

STATE: AK

## LEGEND

Sheet 2 OF 24

Date: 8/4/14

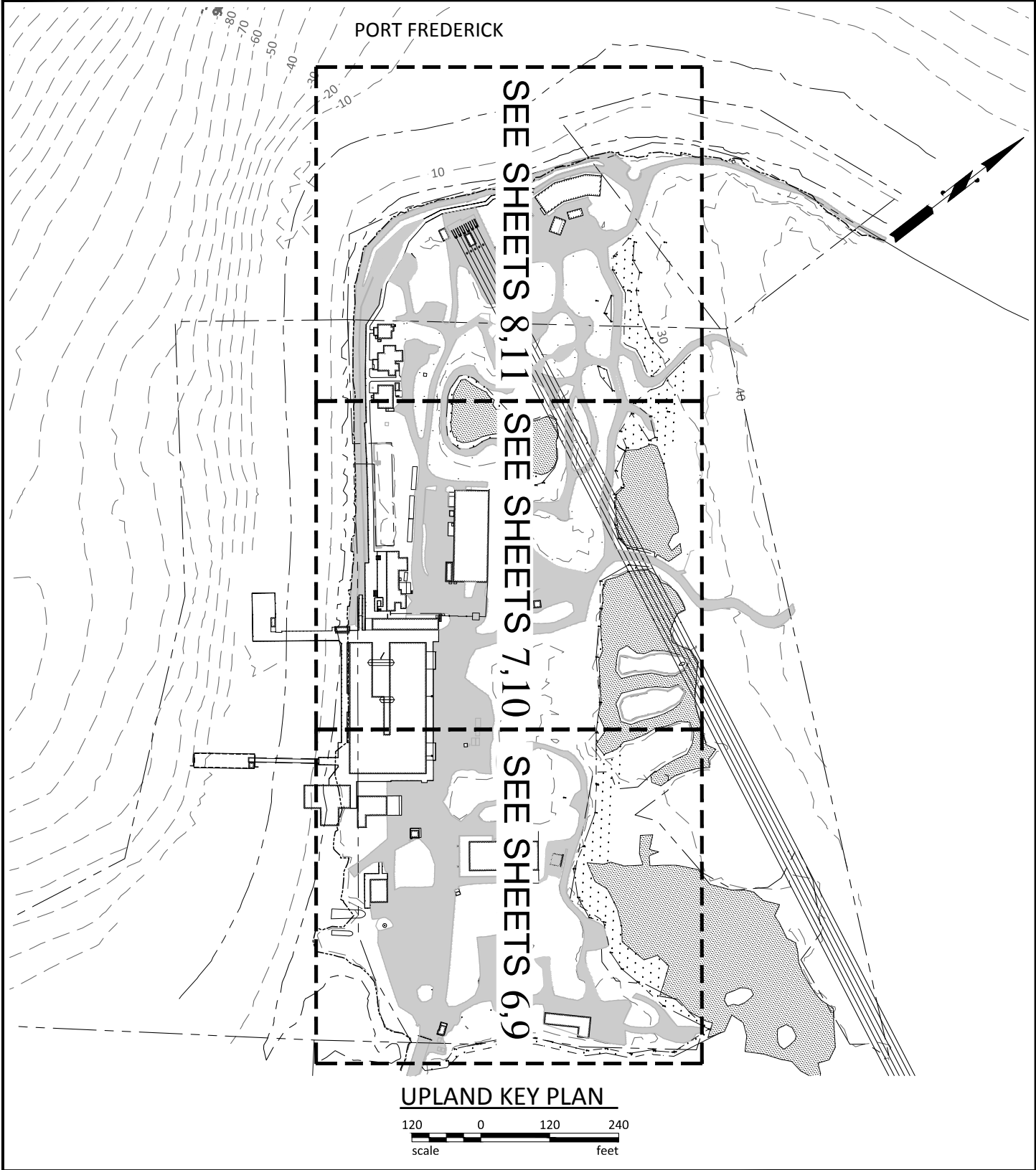

**PROPOSED PROJECT:**  
Proposed Hoonah Berthing Facility and Upland Improvements. Includes in-water and upland construction, upland demolition, and other activities.

**ADJACENT PROPERTY OWNERS:**

- 1) US Forest Service (Tongass)
- 2) City of Hoonah
- 3) Alaska Department of Natural Resources

**USACE REFERENCE NO:** NWS-POA-2012-0404

**APPLICANT:** Huna Totem Corporation

**LOCATION:** 108 Cannery Road, Hoonah, Alaska 99829

**LAT/LONG:** 58.1315306 / 135.465197

**IN:** Icy Strait & Port Frederick

**NEAR:** Hoonah, AK (1.5 miles NW)

**COUNTY:** Hoonah Angoon Borough

**STATE:** AK

### UPLAND KEY PLAN

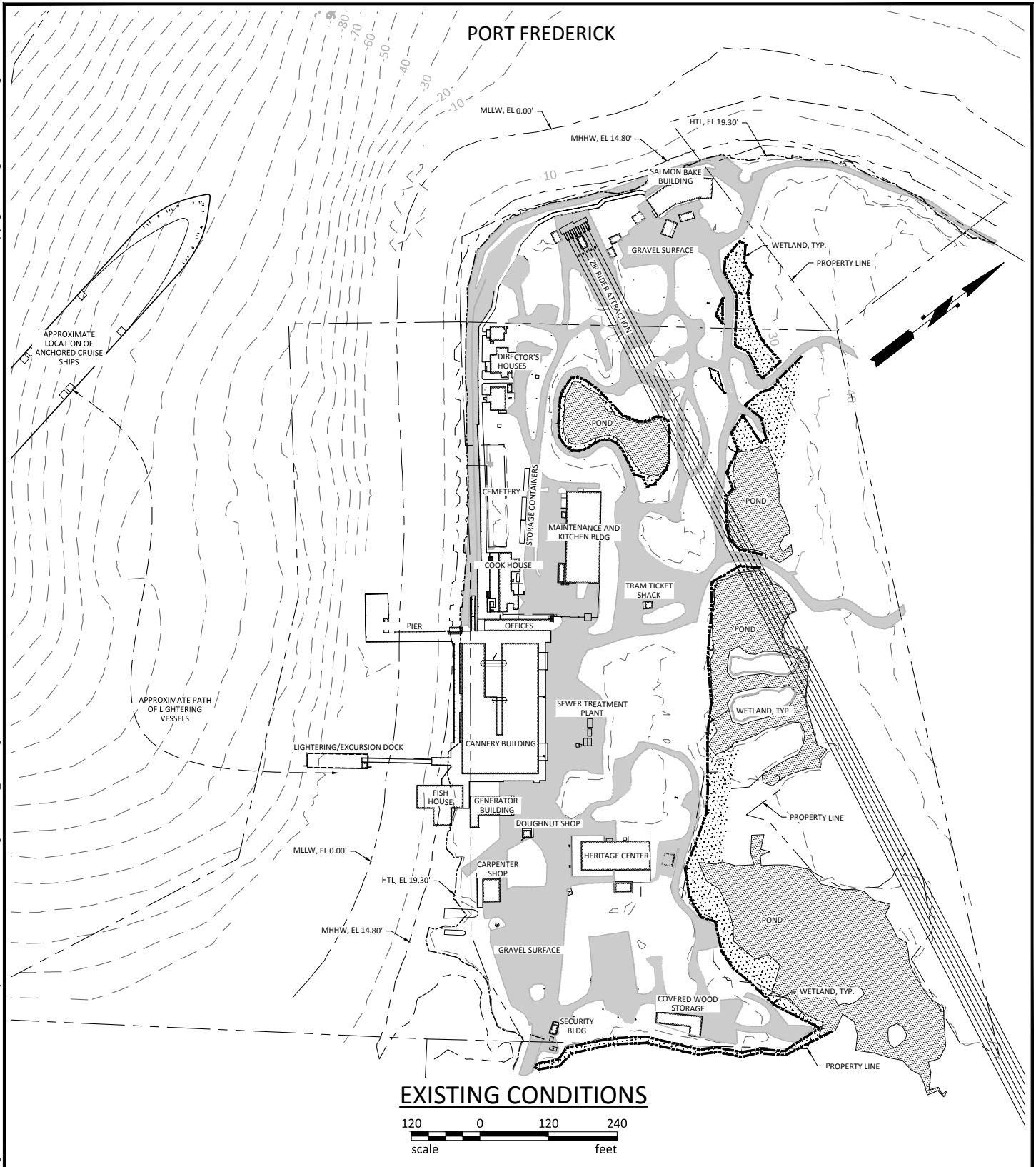

**PROPOSED PROJECT:**  
Proposed Hoonah Berthing Facility and Upland Improvements. Includes in-water and upland construction, upland demolition, and other activities.

**ADJACENT PROPERTY OWNERS:**

- 1) US Forest Service (Tongass)
- 2) City of Hoonah
- 3) Alaska Department of Natural Resources

**USACE REFERENCE NO:** NWS-POA-2012-0404

**APPLICANT:** Huna Totem Corporation

**LOCATION:** 108 Cannery Road, Hoonah, Alaska 99829

**LAT/LONG:** 58.1315306 / 135.465197

**IN:** Icy Strait & Port Frederick

**NEAR:** Hoonah, AK (1.5 miles NW)

**COUNTY:** Hoonah Angoon Borough

**STATE:** AK

## EXISTING CONDITIONS



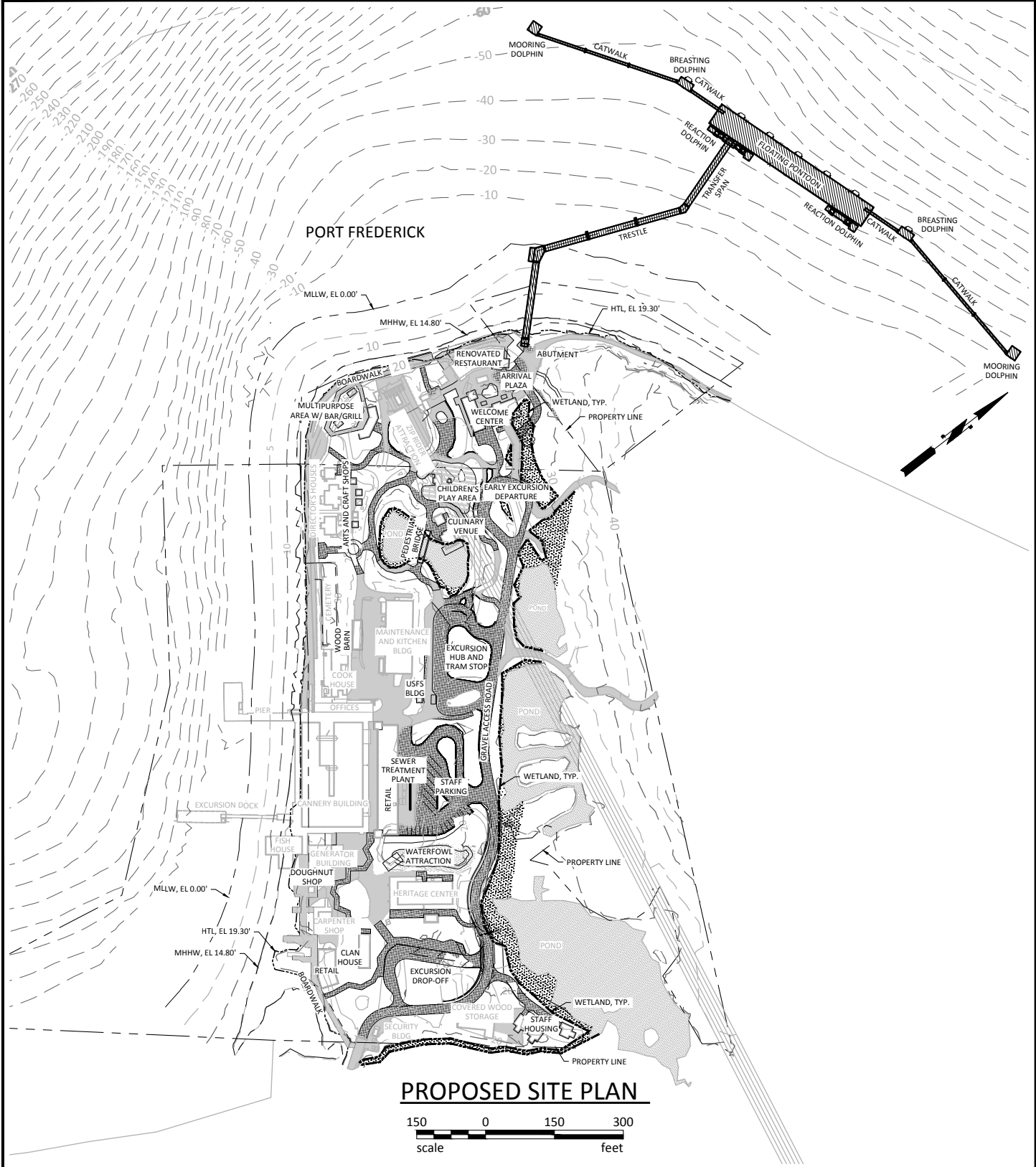

PROPOSED SITE PLAN

150 0 150 300  
scale feet

**PROPOSED PROJECT:**  
Proposed Hoonah Berthing Facility and Upland Improvements. Includes in-water and upland construction, upland demolition, and other activities.

**ADJACENT PROPERTY OWNERS:**

- 1) US Forest Service (Tongass)
- 2) City of Hoonah
- 3) Alaska Department of Natural Resources

**USACE REFERENCE NO:** NWS-POA-2012-0404  
**APPLICANT:** Huna Totem Corporation  
**LOCATION:** 108 Cannery Road, Hoonah, Alaska 99829  
**LAT/LONG:** 58.1315306 / 135.465197  
**IN:** Icy Strait & Port Frederick  
**NEAR:** Hoonah, AK (1.5 miles NW)  
**COUNTY:** Hoonah Angoon Borough  
**STATE:** AK

PROPOSED SITE PLAN

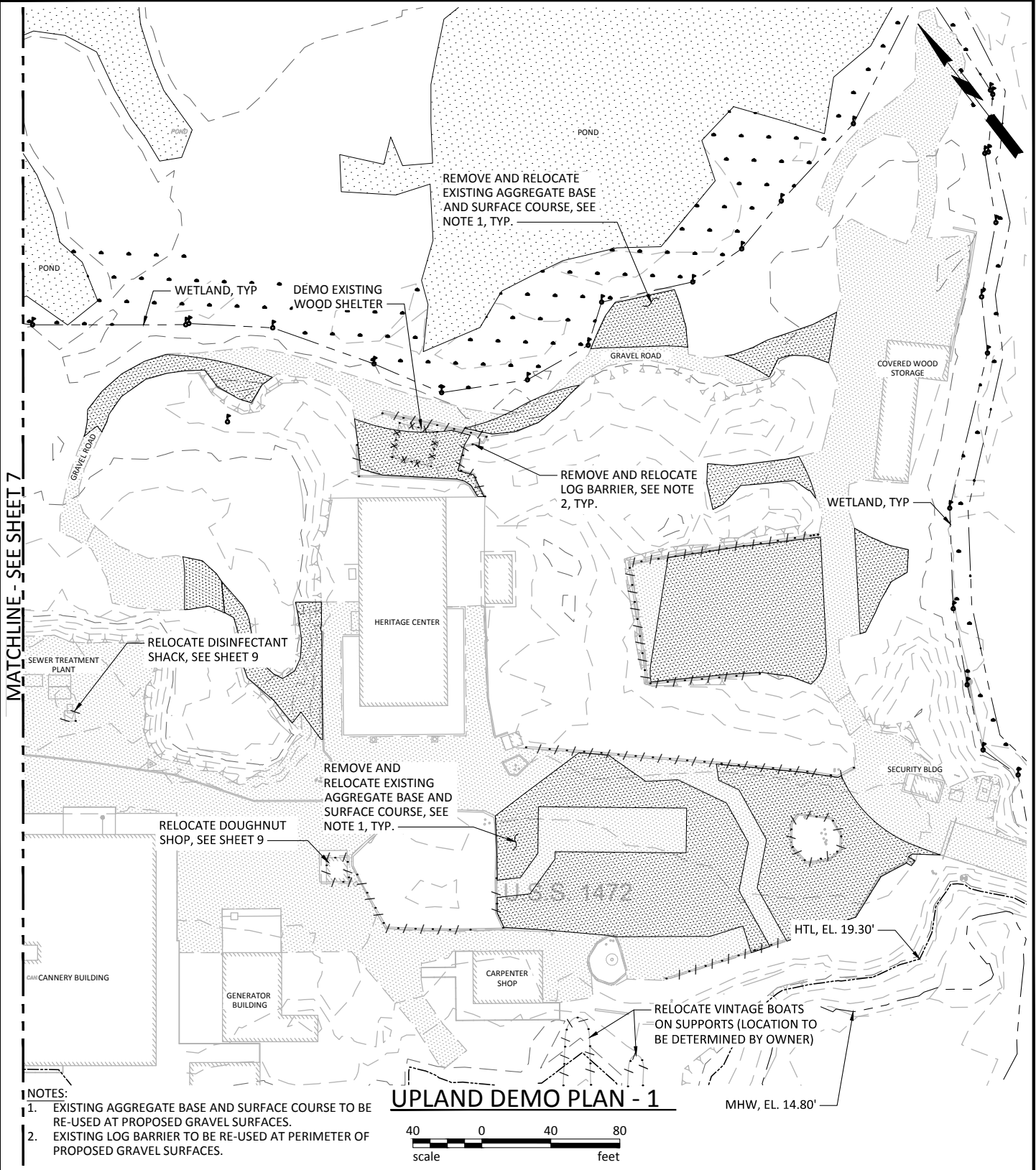

**PROPOSED PROJECT:**  
Proposed Hoonah Berthing Facility and Upland Improvements. Includes in-water and upland construction, upland demolition, and other activities.

**ADJACENT PROPERTY OWNERS:**

- 1) US Forest Service (Tongass)
- 2) City of Hoonah
- 3) Alaska Department of Natural Resources

**USACE REFERENCE NO:** NWS-POA-2012-0404  
**APPLICANT:** Huna Totem Corporation  
**LOCATION:** 108 Cannery Road, Hoonah, Alaska 99829  
**LAT/LONG:** 58.1315306 / 135.465197  
**IN:** Icy Strait & Port Frederick  
**NEAR:** Hoonah, AK (1.5 miles NW)  
**COUNTY:** Hoonah Angoon Borough **STATE:** AK

## UPLAND DEMOLITION PLAN - 1

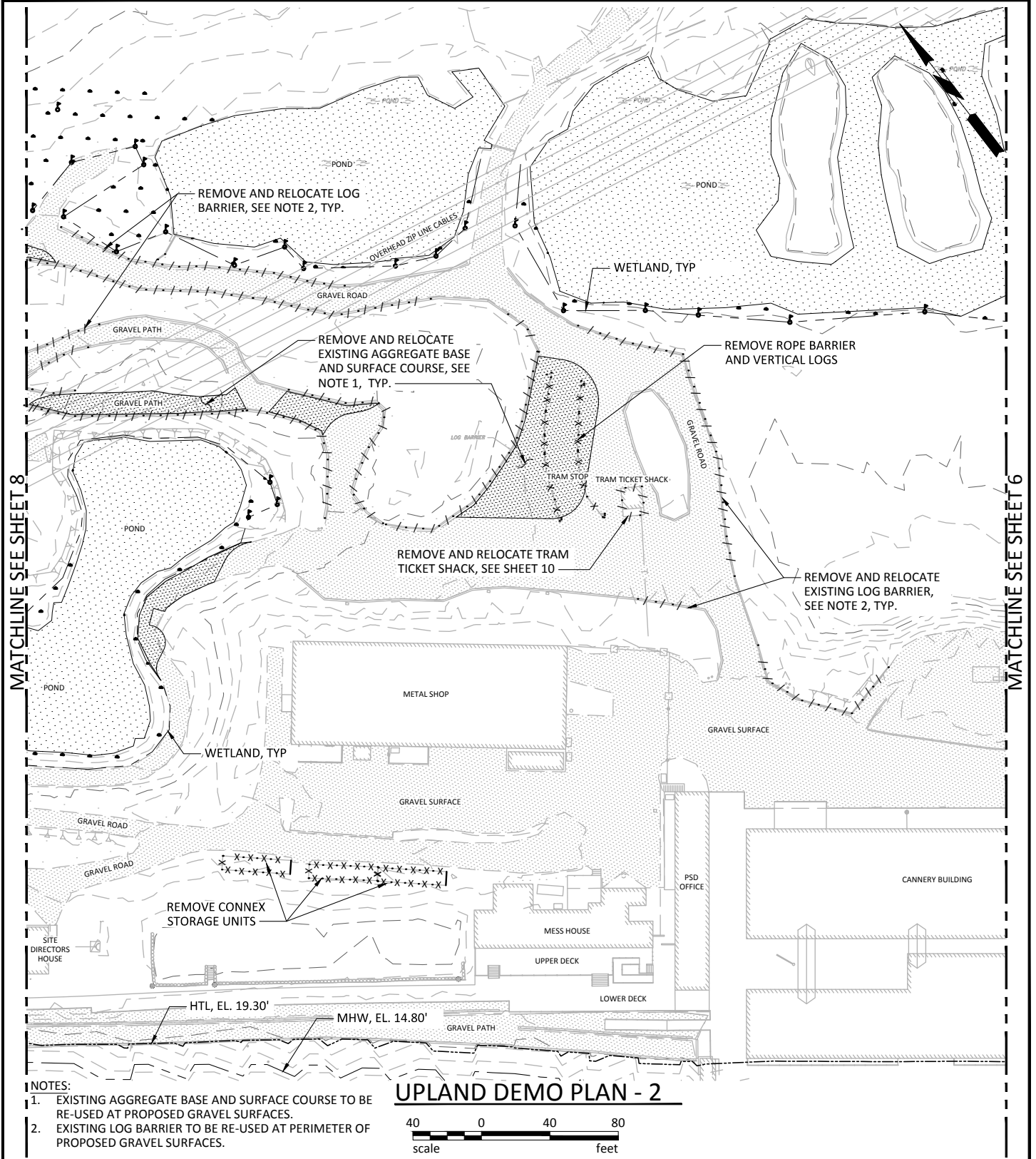

**NOTES:**

1. EXISTING AGGREGATE BASE AND SURFACE COURSE TO BE RE-USED AT PROPOSED GRAVEL SURFACES.
2. EXISTING LOG BARRIER TO BE RE-USED AT PERIMETER OF PROPOSED GRAVEL SURFACES.

**UPLAND DEMO PLAN - 2**



**PROPOSED PROJECT:**

Proposed Hoonah Berthing Facility and Upland Improvements. Includes in-water and upland construction, upland demolition, and other activities.

**ADJACENT PROPERTY OWNERS:**

- 1) US Forest Service (Tongass)
- 2) City of Hoonah
- 3) Alaska Department of Natural Resources

USACE REFERENCE NO: NWS-POA-2012-0404

APPLICANT: Huna Totem Corporation

LOCATION: 108 Cannery Road, Hoonah, Alaska 99829

LAT/LONG: 58.1315306 / 135.465197

IN: Icy Strait & Port Frederick

NEAR: Hoonah, AK (1.5 miles NW)

COUNTY: Hoonah Angoon Borough

STATE: AK

**UPLAND  
DEMOLITION PLAN - 2**

Sheet 7 OF 24

Date: 8/4/14

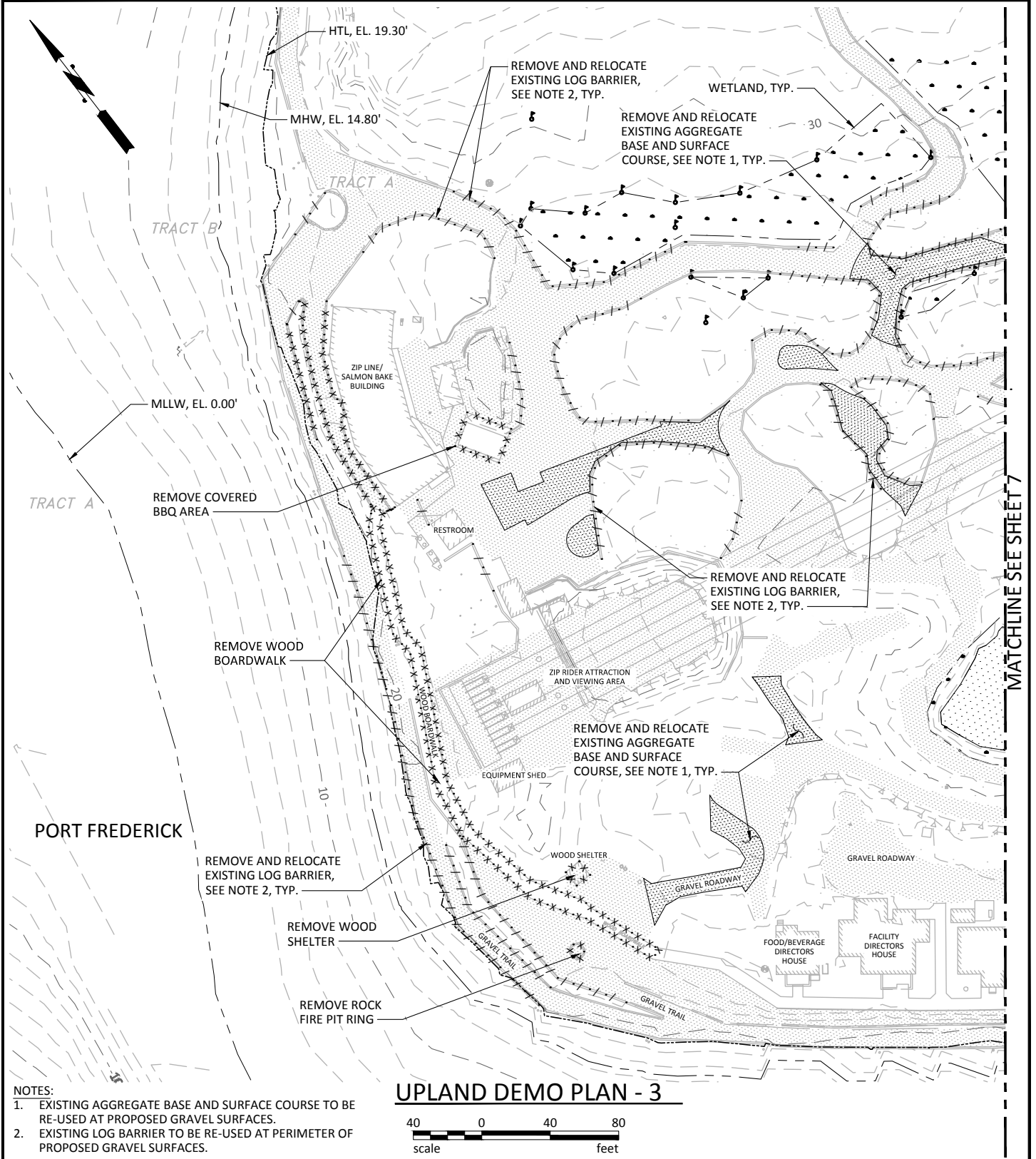

**PROPOSED PROJECT:**  
Proposed Hoonah Berthing Facility and Upland Improvements. Includes in-water and upland construction, upland demolition, and other activities.

**ADJACENT PROPERTY OWNERS:**

- 1) US Forest Service (Tongass)
- 2) City of Hoonah
- 3) Alaska Department of Natural Resources

**USACE REFERENCE NO:** NWS-POA-2012-0404  
**APPLICANT:** Huna Totem Corporation  
**LOCATION:** 108 Cannery Road, Hoonah, Alaska 99829  
**LAT/LONG:** 58.1315306 / 135.465197  
**IN:** Icy Strait & Port Frederick  
**NEAR:** Hoonah, AK (1.5 miles NW)  
**COUNTY:** Hoonah Angoon Borough  
**STATE:** AK

**UPLAND  
DEMOLITION PLAN - 3**



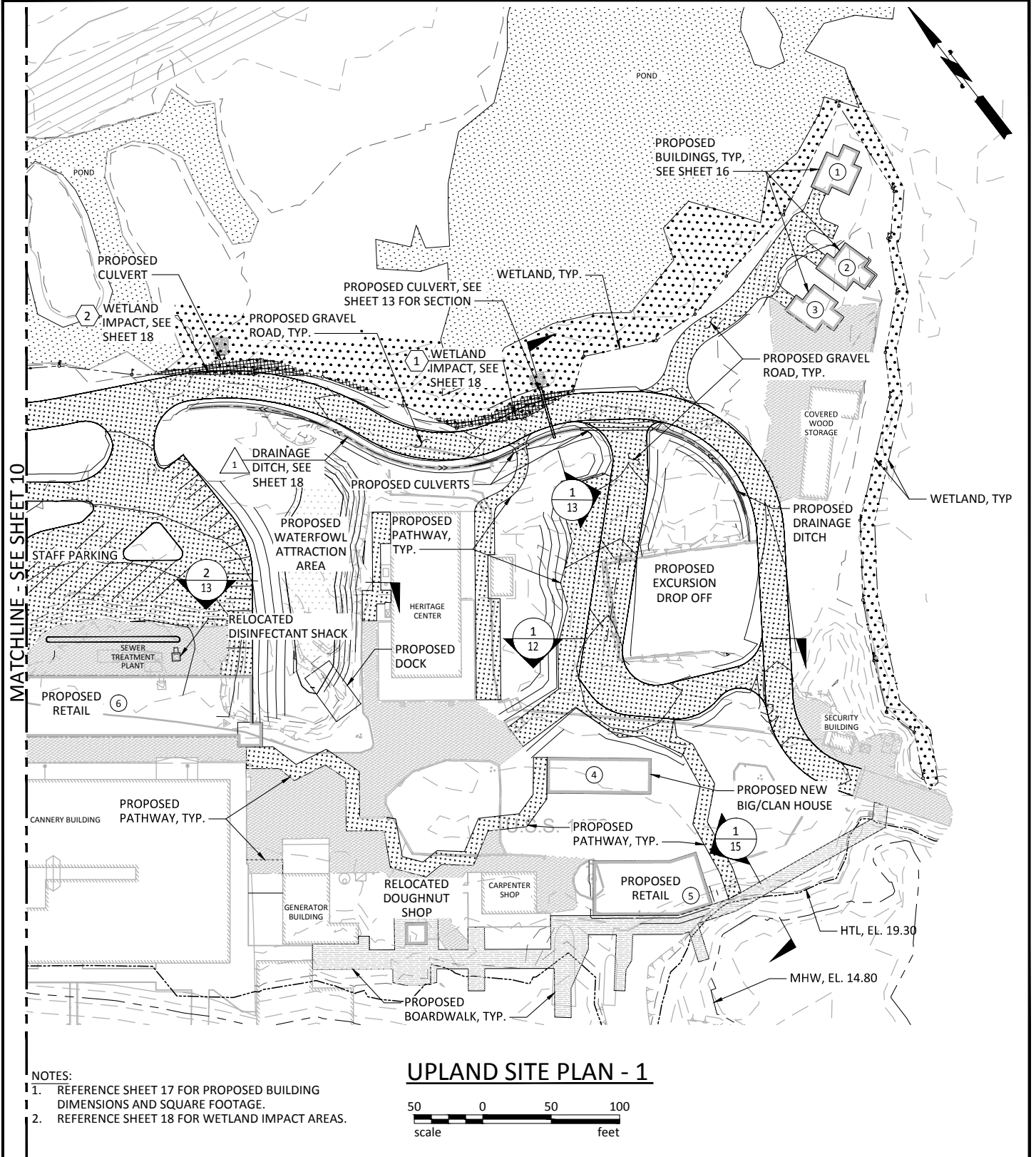

PROPOSED PROJECT:  
Proposed Hoonah Berthing Facility and Upland Improvements. Includes in-water and upland construction, upland demolition, and other activities.

ADJACENT PROPERTY OWNERS:

- 1) US Forest Service (Tongass)
- 2) City of Hoonah
- 3) Alaska Department of Natural Resources

USACE REFERENCE NO: NWS-POA-2012-0404  
APPLICANT: Huna Totem Corporation  
LOCATION: 108 Cannery Road, Hoonah, Alaska 99829  
LAT/LONG: 58.1315306 / 135.465197  
IN: Icy Strait & Port Frederick  
NEAR: Hoonah, AK (1.5 miles NW)  
COUNTY: Hoonah Angoon Borough STATE: AK

## UPLAND SITE PLAN - 1

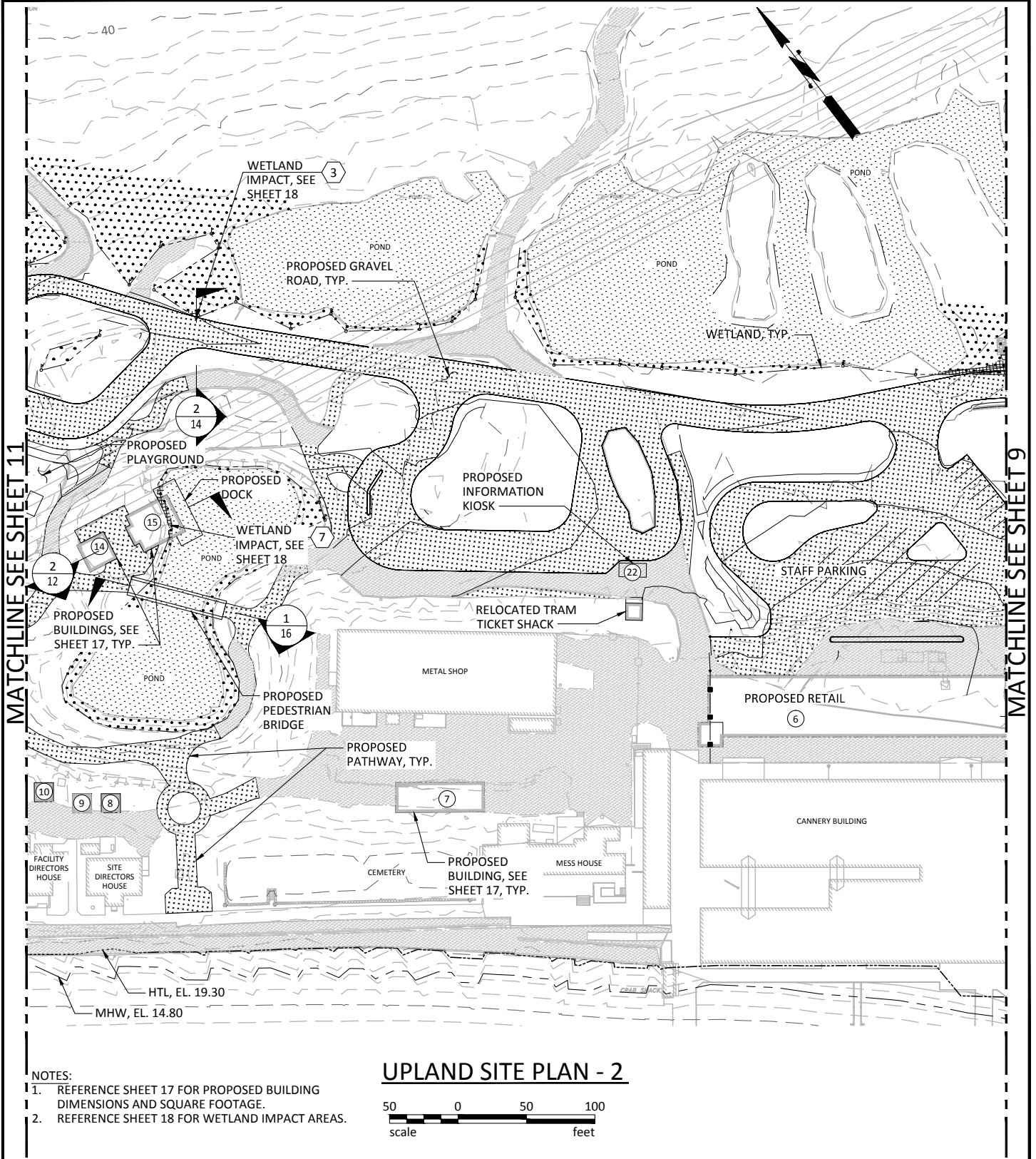

NOTES:

1. REFERENCE SHEET 17 FOR PROPOSED BUILDING DIMENSIONS AND SQUARE FOOTAGE.
2. REFERENCE SHEET 18 FOR WETLAND IMPACT AREAS.

UPLAND SITE PLAN - 2



PROPOSED PROJECT:  
Proposed Hoonah Berthing Facility and Upland Improvements. Includes in-water and upland construction, upland demolition, and other activities.

ADJACENT PROPERTY OWNERS:  
1) US Forest Service (Tongass)  
2) City of Hoonah  
3) Alaska Department of Natural Resources

USACE REFERENCE NO: NWS-POA-2012-0404  
APPLICANT: Huna Totem Corporation  
LOCATION: 108 Cannery Road, Hoonah, Alaska 99829  
LAT/LONG: 58.1315306 / 135.465197  
IN: Icy Strait & Port Frederick  
NEAR: Hoonah, AK (1.5 miles NW)  
COUNTY: Hoonah Angoon Borough STATE: AK

UPLAND  
SITE PLAN - 2

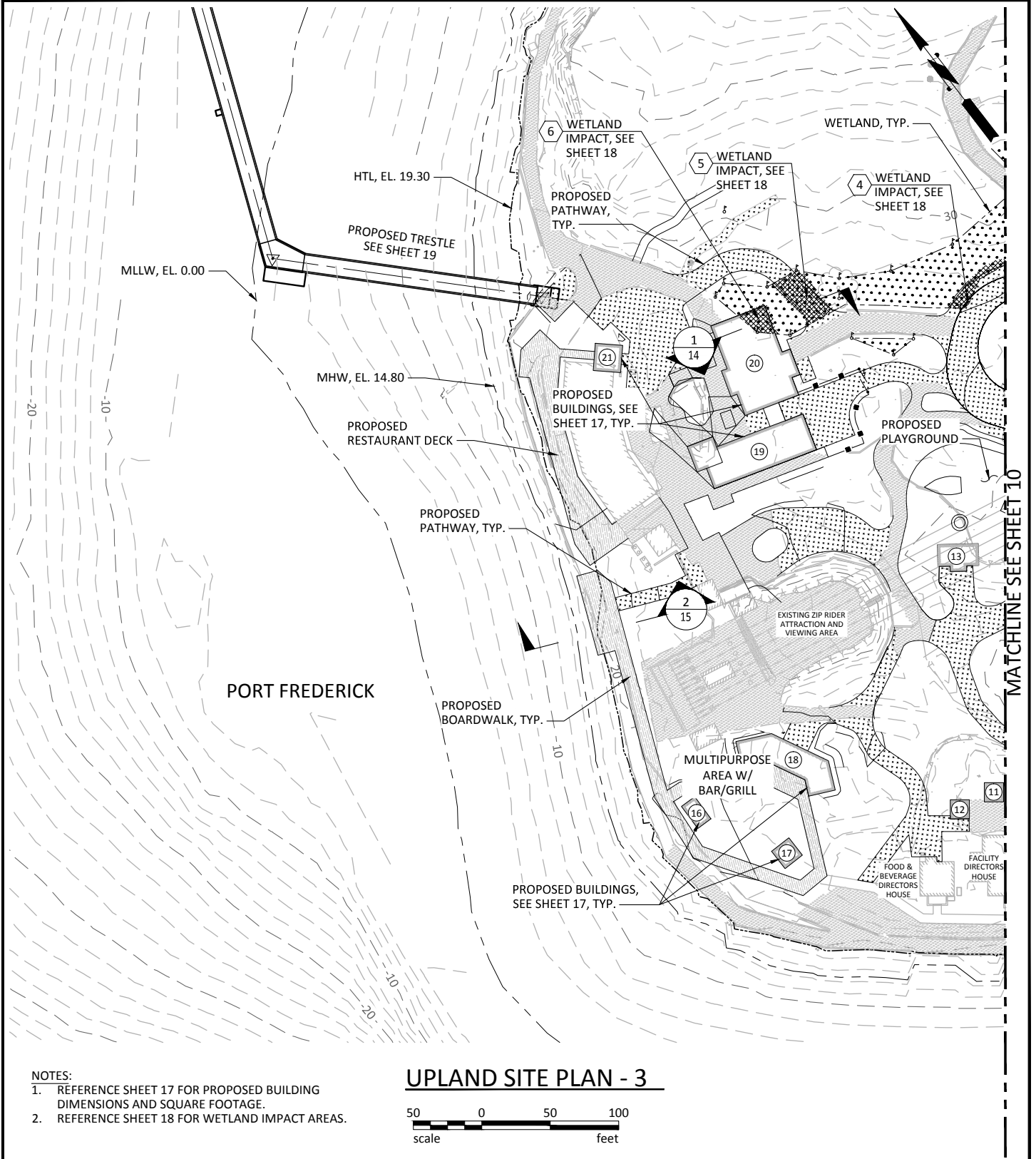

- NOTES:**
1. REFERENCE SHEET 17 FOR PROPOSED BUILDING DIMENSIONS AND SQUARE FOOTAGE.
  2. REFERENCE SHEET 18 FOR WETLAND IMPACT AREAS.

### UPLAND SITE PLAN - 3



**PROPOSED PROJECT:**  
 Proposed Hoonah Berthing Facility and Upland Improvements. Includes in-water and upland construction, upland demolition, and other activities.

**ADJACENT PROPERTY OWNERS:**

- 1) US Forest Service (Tongass)
- 2) City of Hoonah
- 3) Alaska Department of Natural Resources

**USACE REFERENCE NO:** NWS-POA-2012-0404  
**APPLICANT:** Huna Totem Corporation  
**LOCATION:** 108 Cannery Road, Hoonah, Alaska 99829  
**LAT/LONG:** 58.1315306 / 135.465197  
**IN:** Icy Strait & Port Frederick  
**NEAR:** Hoonah, AK (1.5 miles NW)  
**COUNTY:** Hoonah Angoon Borough **STATE:** AK

### UPLAND SITE PLAN - 3

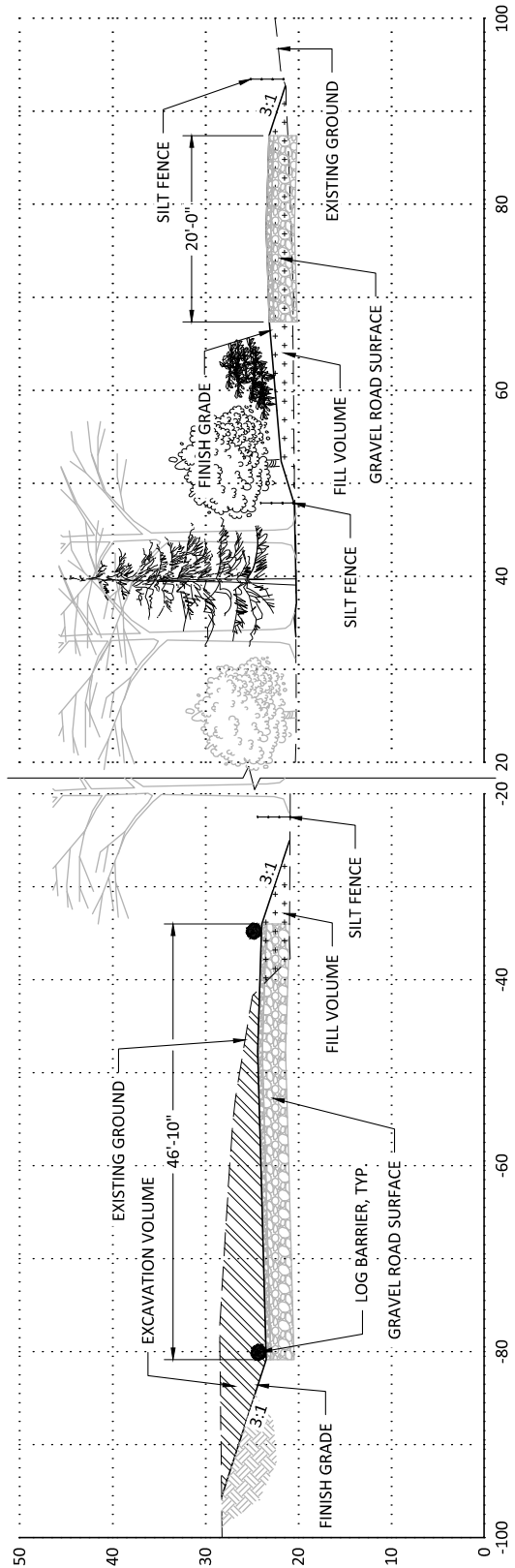

### EXCURSION DROP-OFF AND ROAD PROFILE

SECTION NUMBER, TYP 1  
SHEET WHERE SECTION IS SHOWN, TYP 9

1" = 10' scale

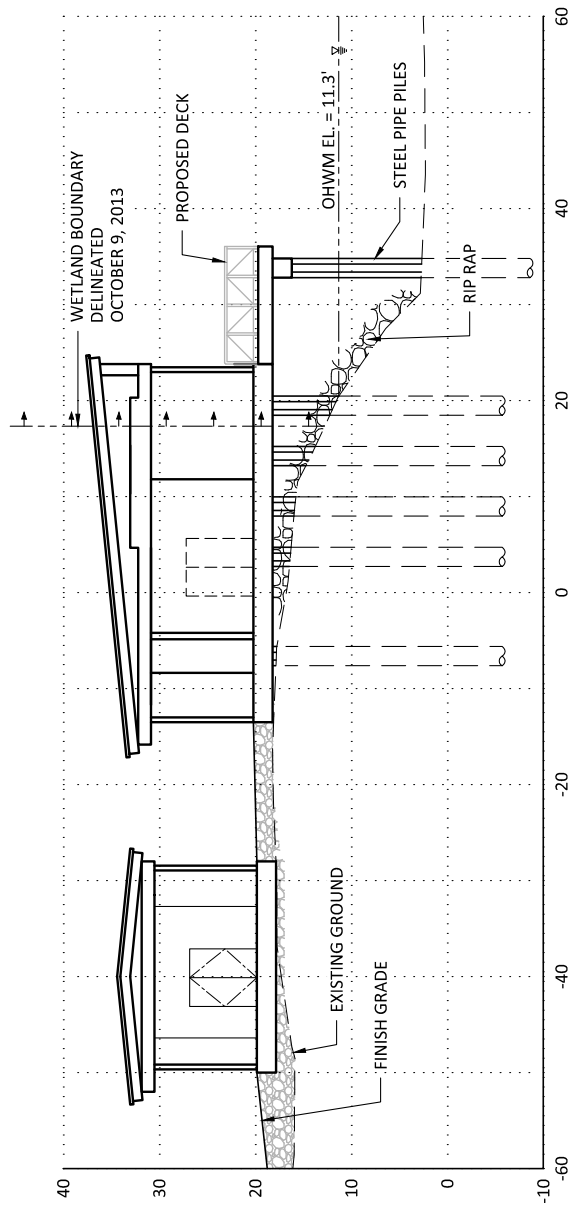

### CULINARY VENUE PROFILE

2  
10

1" = 10' scale

**PROPOSED PROJECT:**  
Proposed Hoonah Berthing Facility and Upland Improvements. Includes in-water and upland construction, upland demolition, and other activities.

**ADJACENT PROPERTY OWNERS:**  
1) US Forest Service (Tongass)  
2) City of Hoonah  
3) Alaska Department of Natural Resources

**USACE REFERENCE NO:** NWS-POA-2012-0404  
**APPLICANT:** Huna Totem Corporation  
**LOCATION:** 108 Cannery Road, Hoonah, Alaska 99829  
**LAT/LONG:** 58.1315306 / 135.465197  
**IN:** Icy Strait & Port Frederick  
**NEAR:** Hoonah, AK (1.5 miles NW)  
**COUNTY:** Hoonah Angoon Borough

**STATE:** AK

### UPLAND SECTIONS

Sheet 12 OF 24

Date: 8/4/14



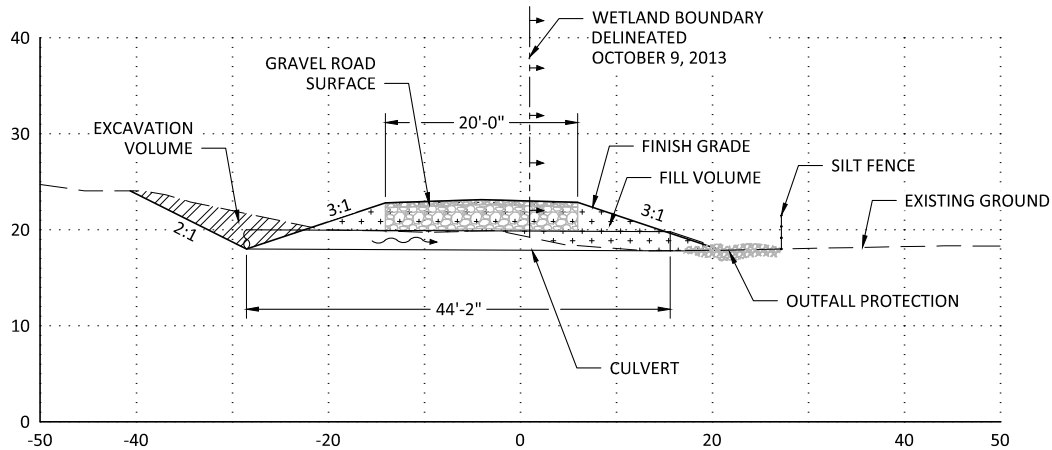

SECTION NUMBER, TYP 1 ROAD SECTION AT CULVERT  
SHEET WHERE SECTION IS SHOWN, TYP 9  
1" = 10'  scale feet

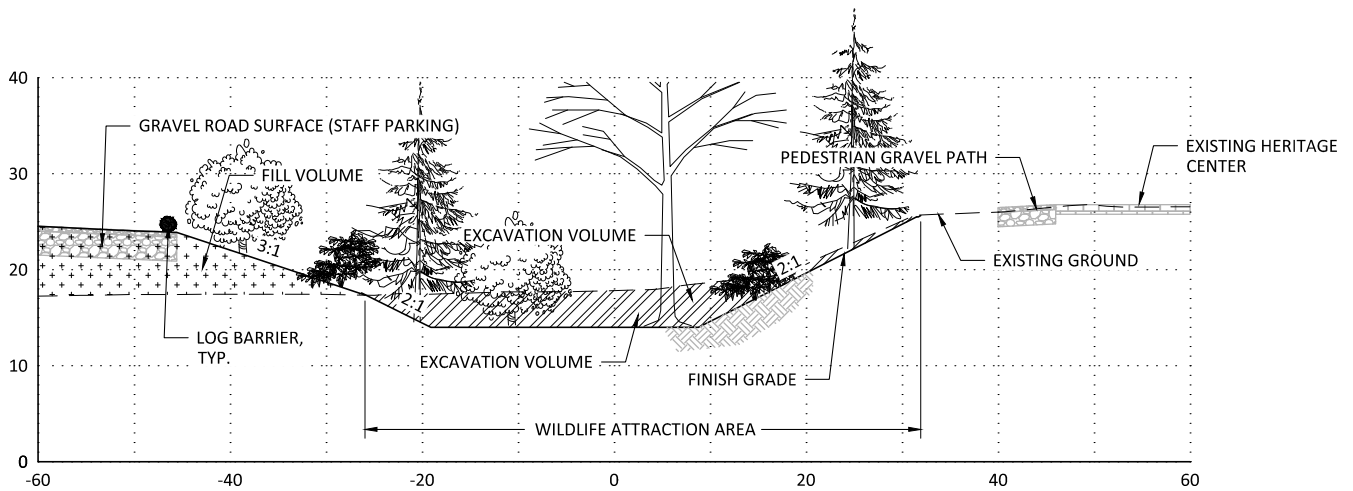

2 WATERFOWL ATTRACTION PROFILE  
9  
1" = 10'  scale feet

**PROPOSED PROJECT:**  
Proposed Hoonah Berthing Facility and Upland Improvements. Includes in-water and upland construction, upland demolition, and other activities.

**ADJACENT PROPERTY OWNERS:**

- 1) US Forest Service (Tongass)
- 2) City of Hoonah
- 3) Alaska Department of Natural Resources

**USACE REFERENCE NO:** NWS-POA-2012-0404  
**APPLICANT:** Huna Totem Corporation  
**LOCATION:** 108 Cannery Road, Hoonah, Alaska 99829  
**LAT/LONG:** 58.1315306 / 135.465197  
**IN:** Icy Strait & Port Frederick  
**NEAR:** Hoonah, AK (1.5 miles NW)  
**COUNTY:** Hoonah Angoon Borough **STATE:** AK

## UPLAND SECTIONS

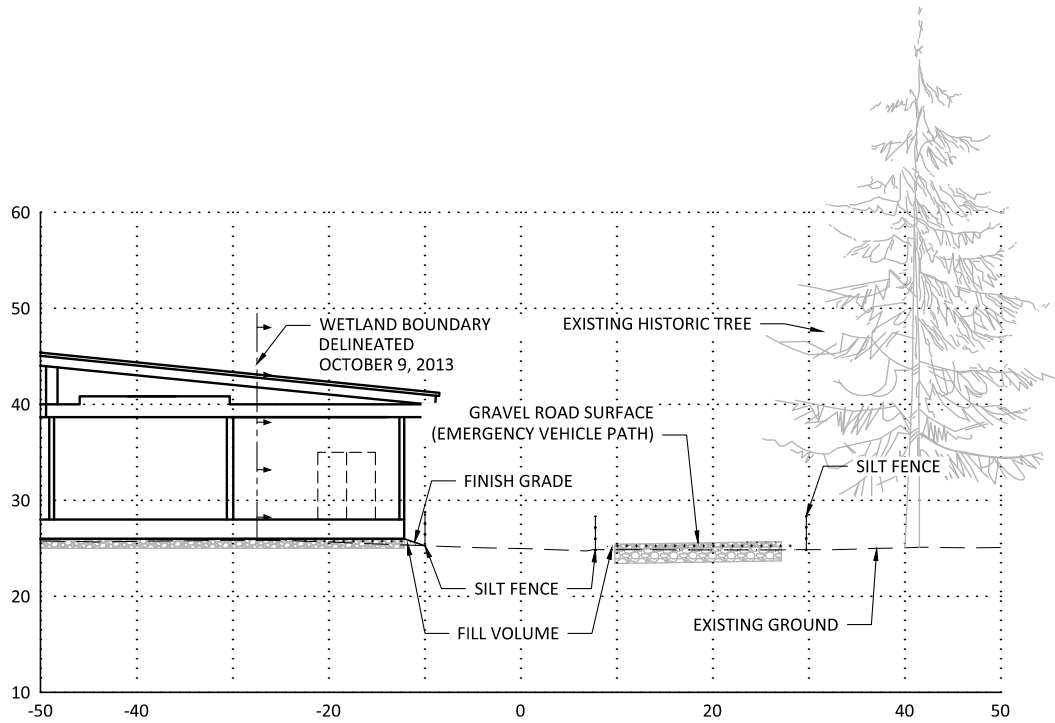

SECTION NUMBER, TYP **1**  
**WELCOME CENTER/GRAVEL ACCESS ROAD SECTION**  
 SHEET WHERE SECTION IS SHOWN, TYP **11**  
 1" = 10' scale 10 0 10 20 feet

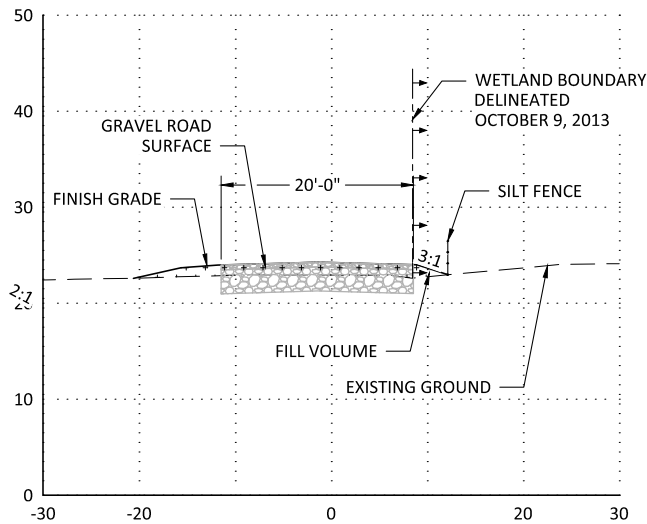

**2**  
**GRAVEL ROAD SECTION**  
 1" = 10' scale 10 0 10 20 feet

**PROPOSED PROJECT:**  
 Proposed Hoonah Berthing Facility and Upland Improvements. Includes in-water and upland construction, upland demolition, and other activities.

**ADJACENT PROPERTY OWNERS:**

- 1) US Forest Service (Tongass)
- 2) City of Hoonah
- 3) Alaska Department of Natural Resources

**USACE REFERENCE NO:** NWS-POA-2012-0404

**APPLICANT:** Huna Totem Corporation

**LOCATION:** 108 Cannery Road, Hoonah, Alaska 99829

**LAT/LONG:** 58.1315306 / 135.465197

**IN:** Icy Strait & Port Frederick

**NEAR:** Hoonah, AK (1.5 miles NW)

**COUNTY:** Hoonah Angoon Borough **STATE:** AK

## UPLAND SECTIONS

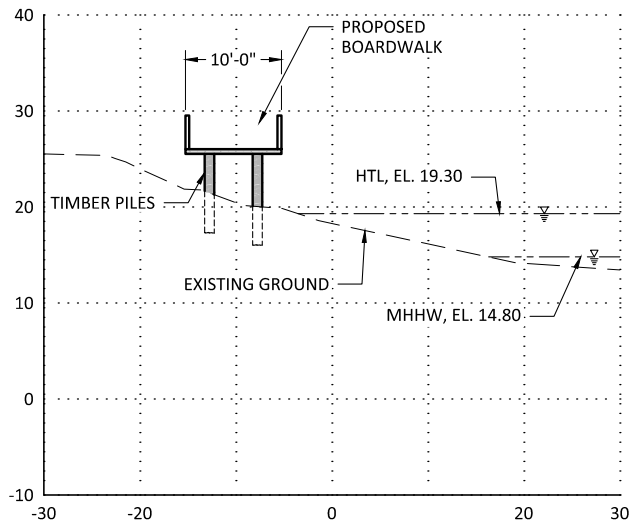

SECTION NUMBER, TYPE **1** **BOARDWALK SECTION**  
SHEET WHERE SECTION IS SHOWN, TYPE **9**  
1" = 10'  
scale 10 0 10 20 feet

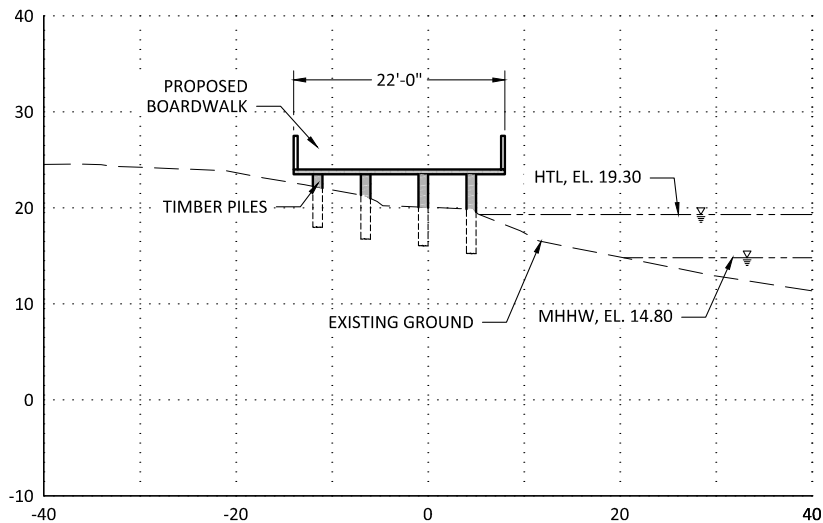

**2** **BOARDWALK SECTION**  
**11**  
1" = 10'  
scale 10 0 10 20 feet

**PROPOSED PROJECT:**  
Proposed Hoonah Berthing Facility and Upland Improvements. Includes in-water and upland construction, upland demolition, and other activities.

**ADJACENT PROPERTY OWNERS:**

- 1) US Forest Service (Tongass)
- 2) City of Hoonah
- 3) Alaska Department of Natural Resources

**USACE REFERENCE NO:** NWS-POA-2012-0404  
**APPLICANT:** Huna Totem Corporation  
**LOCATION:** 108 Cannery Road, Hoonah, Alaska 99829  
**LAT/LONG:** 58.1315306 / 135.465197  
**IN:** Icy Strait & Port Frederick  
**NEAR:** Hoonah, AK (1.5 miles NW)  
**COUNTY:** Hoonah Angoon Borough **STATE:** AK

## UPLAND SECTIONS

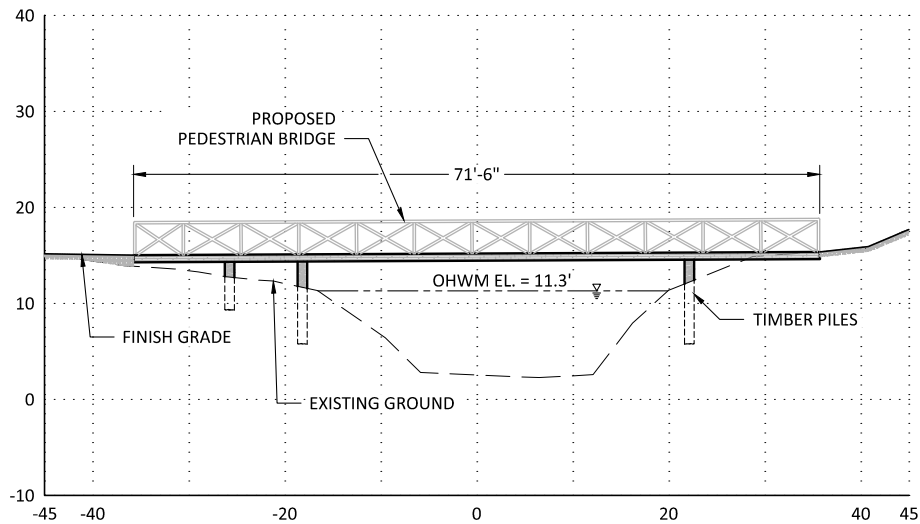

SECTION NUMBER, TYP 1 **PEDESTRIAN BRIDGE SECTION**  
SHEET WHERE SECTION IS SHOWN, TYP 10  
1" = 10' 

10

0

10

20

  
scale feet

**PROPOSED PROJECT:**  
Proposed Hoonah Berthing Facility and Upland Improvements. Includes in-water and upland construction, upland demolition, and other activities.

**ADJACENT PROPERTY OWNERS:**

- 1) US Forest Service (Tongass)
- 2) City of Hoonah
- 3) Alaska Department of Natural Resources

**USACE REFERENCE NO:** NWS-POA-2012-0404

**APPLICANT:** Huna Totem Corporation

**LOCATION:** 108 Cannery Road, Hoonah, Alaska 99829

**LAT/LONG:** 58.1315306 / 135.465197

**IN:** Icy Strait & Port Frederick



**NEAR:** Hoonah, AK (1.5 miles NW)

**COUNTY:** Hoonah Angoon Borough **STATE:** AK

## UPLAND SECTIONS

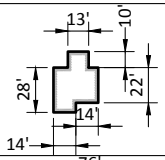
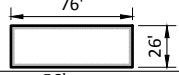
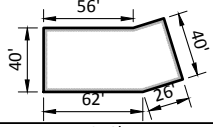
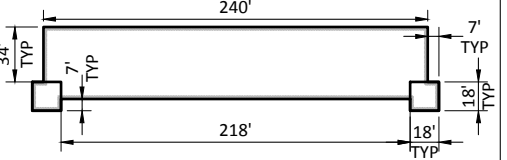
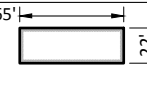

### UPLAND BUILDING TABLE

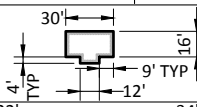
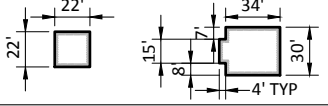
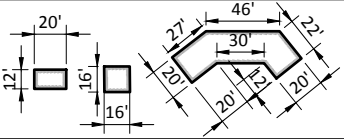
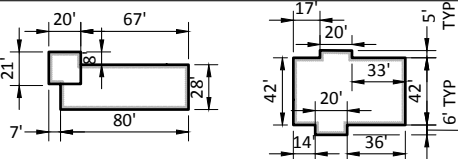
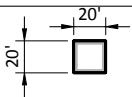
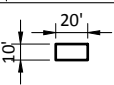
| ID #      | BUILDING NAME                       | DIMENSIONS (FT)  | TOTAL SQUARE FEET |
|-----------|-------------------------------------|--|-------------------|
| ① ② ③     | STAFF HOUSING<br>1,2 & 3            |     | 2,500 SF          |
| ④         | NEW<br>BIG/CLAN HOUSE               |     | 2,000 SF          |
| ⑤         | PROPOSED RETAIL 1                   |     | 3,285 SF          |
| ⑥         | PROPOSED RETAIL 2                   |    | 11,500 SF         |
| ⑦         | NEW WOOD BARN                       |     | 1,450 SF          |
| ⑧ ⑨ ⑩ ⑪ ⑫ | ARTS & CRAFTS SHOPS                 |     | 1,000 SF          |
| ⑬         | CHILDREN'S PLAY<br>AREA BUILDING    |    | 625 SF            |
| ⑭ ⑮       | CULINARY VENUE                      |  | 1,600 SF          |
| ⑯ ⑰ ⑱     | MULTIPURPOSE AREA<br>W/ BAR/GRILL   |  | 2,150 SF          |
| ⑲ ⑳       | WELCOME CENTER<br>W/ RETAIL         |  | 6,100 SF          |
| ㉑         | RENOVATED<br>RESTAURANT<br>ADDITION |   | 6,100 SF          |
| ㉒         | INFORMATION KIOSK                   |   | 200 SF            |

**PROPOSED PROJECT:**  
Proposed Hoonah Berthing Facility and Upland Improvements. Includes in-water and upland construction, upland demolition, and other activities.

**ADJACENT PROPERTY OWNERS:**  
1) US Forest Service (Tongass)  
2) City of Hoonah  
3) Alaska Department of Natural Resources

**USACE REFERENCE NO:** NWS-POA-2012-0404  
**APPLICANT:** Huna Totem Corporation  
**LOCATION:** 108 Cannery Road, Hoonah, Alaska 99829  
**LAT/LONG:** 58.1315306 / 135.465197  
**IN:** Icy Strait & Port Frederick  
**NEAR:** Hoonah, AK (1.5 miles NW)  
**COUNTY:** Hoonah Angoon Borough **STATE:** AK

### UPLAND BUILDING TABLE

## WETLAND IMPACT TABLE

| ID # | AREA (SQUARE FEET) | CUT (CUBIC YARDS) | FILL (CUBIC YARDS) |
|------|--------------------|-------------------|--------------------|
| 1    | 900                | 0                 | 120                |
| 2    | 1,200              | 0                 | 100                |
| 3    | 50                 | 0                 | 5                  |
| 4    | 500                | 15                | 5                  |
| 5    | 1,000              | 0                 | 30                 |
| 6    | 300                | 0                 | 10                 |
| 7    | 150                | 0                 | 5                  |

## DRAINAGE DITCH TABLE

| ID # | AREA (SQUARE FEET) | CUT (CUBIC YARDS) | FILL (CUBIC YARDS) |
|------|--------------------|-------------------|--------------------|
| 1    | 900                | 520               | 20                 |

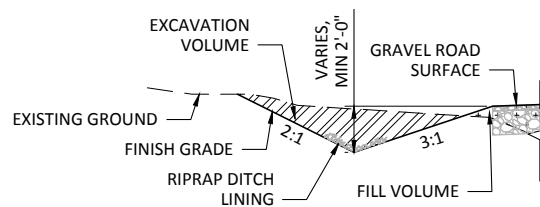
TYPICAL DITCH SECTION

## PROPOSED PROJECT:

Proposed Hoonah Berthing Facility and Upland Improvements. Includes in-water and upland construction, upland demolition, and other activities.

## ADJACENT PROPERTY OWNERS:

- 1) US Forest Service (Tongass)
- 2) City of Hoonah
- 3) Alaska Department of Natural Resources

USACE REFERENCE NO: NWS-POA-2012-0404

APPLICANT: Huna Totem Corporation

LOCATION: 108 Cannery Road, Hoonah, Alaska 99829

LAT/LONG: 58.1315306 / 135.465197

IN: Icy Strait & Port Frederick

NEAR: Hoonah, AK (1.5 miles NW)

COUNTY: Hoonah Angoon Borough

STATE: AK

WETLAND IMPACT TABLE  
AND DITCH TABLE

Sheet 18 OF 24

Date: 8/4/14

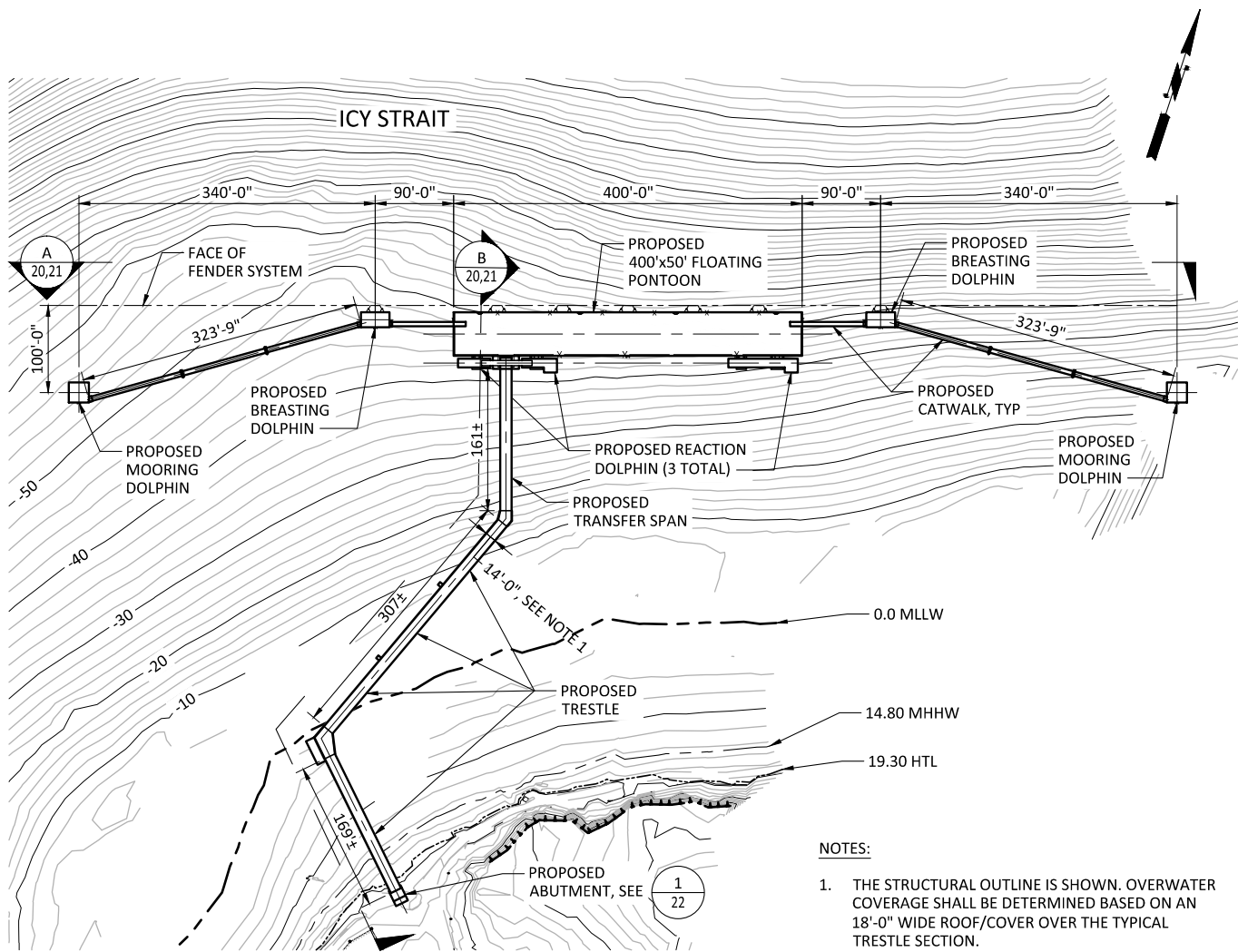

NOTES:

1. THE STRUCTURAL OUTLINE IS SHOWN. OVERWATER COVERAGE SHALL BE DETERMINED BASED ON AN 18'-0" WIDE ROOF/COVER OVER THE TYPICAL TRESTLE SECTION.

**SITE PLAN - PROPOSED BERTHING FACILITY**

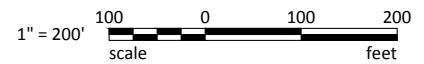

**PROPOSED PROJECT:**  
Proposed Hoonah Berthing Facility and Upland Improvements. Includes in-water and upland construction, upland demolition, and other activities.

**ADJACENT PROPERTY OWNERS:**

- 1) US Forest Service (Tongass)
- 2) City of Hoonah
- 3) Alaska Department of Natural Resources

**USACE REFERENCE NO:** NWS-POA-2012-0404

**APPLICANT:** Huna Totem Corporation

**LOCATION:** 108 Cannery Road, Hoonah, Alaska 99829

**LAT/LONG:** 58.1315306 / 135.465197

**IN:** Icy Strait & Port Frederick

**NEAR:** Hoonah, AK (1.5 miles NW)

**COUNTY:** Hoonah Angoon Borough      **STATE:** AK

**BERTHING FACILITY**

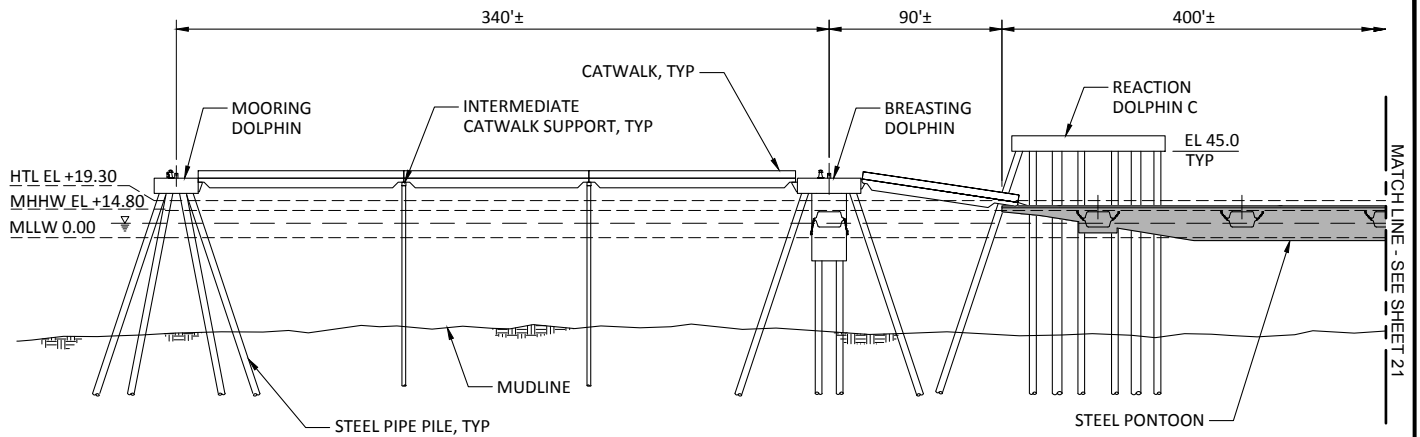

A  
19

### ELEVATION - PROPOSED BERTHING FACILITY (EAST)

1" = 100'

50 0 50 100  
scale feet

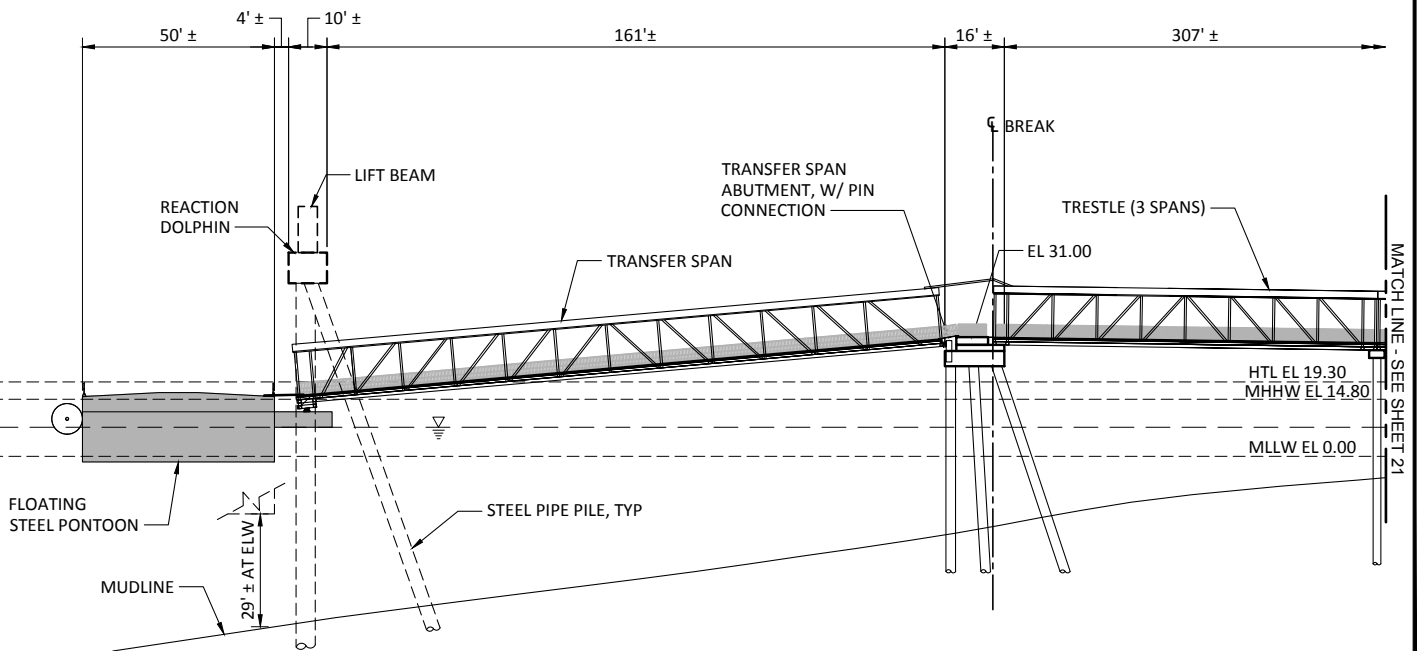

B  
19

### ELEVATION - TRESTLE AND TRANSFER SPAN (NORTH)

1" = 50'

25 0 25 50  
scale feet

**PROPOSED PROJECT:**  
Proposed Hoonah Berthing Facility and Upland Improvements. Includes in-water and upland construction, upland demolition, and other activities.

**ADJACENT PROPERTY OWNERS:**  
1) US Forest Service (Tongass)  
2) City of Hoonah  
3) Alaska Department of Natural Resources

**USACE REFERENCE NO:** NWS-POA-2012-0404  
**APPLICANT:** Huna Totem Corporation  
**LOCATION:** 108 Cannery Road, Hoonah, Alaska 99829  
**LAT/LONG:** 58.1315306 / 135.465197  
**IN:** Icy Strait & Port Frederick  
**NEAR:** Hoonah, AK (1.5 miles NW)  
**COUNTY:** Hoonah Angoon Borough  
**STATE:** AK

### BERTHING FACILITY



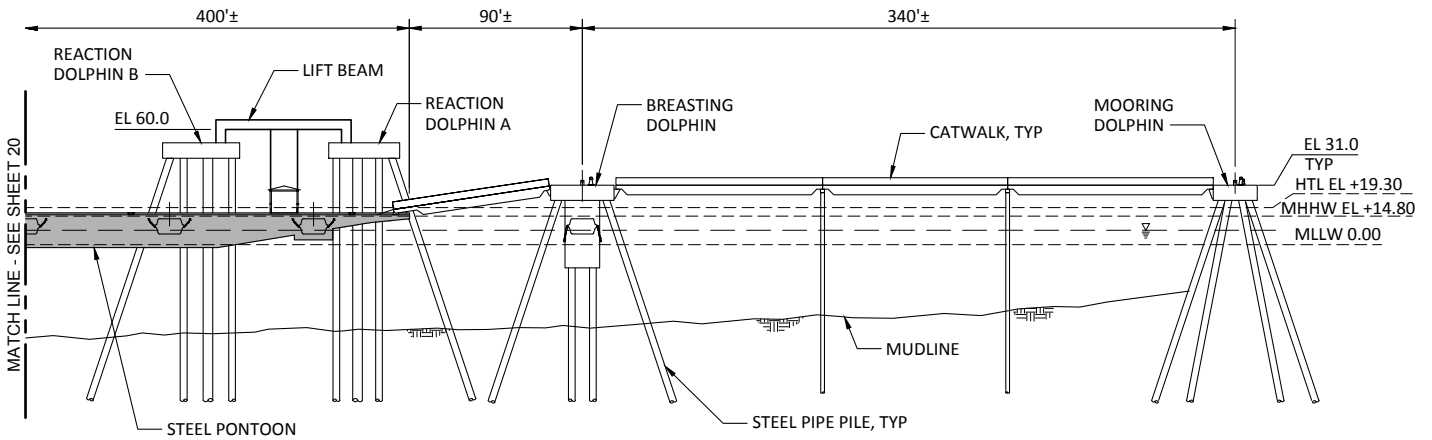

**ELEVATION - PROPOSED BERTHING FACILITY (WEST)**

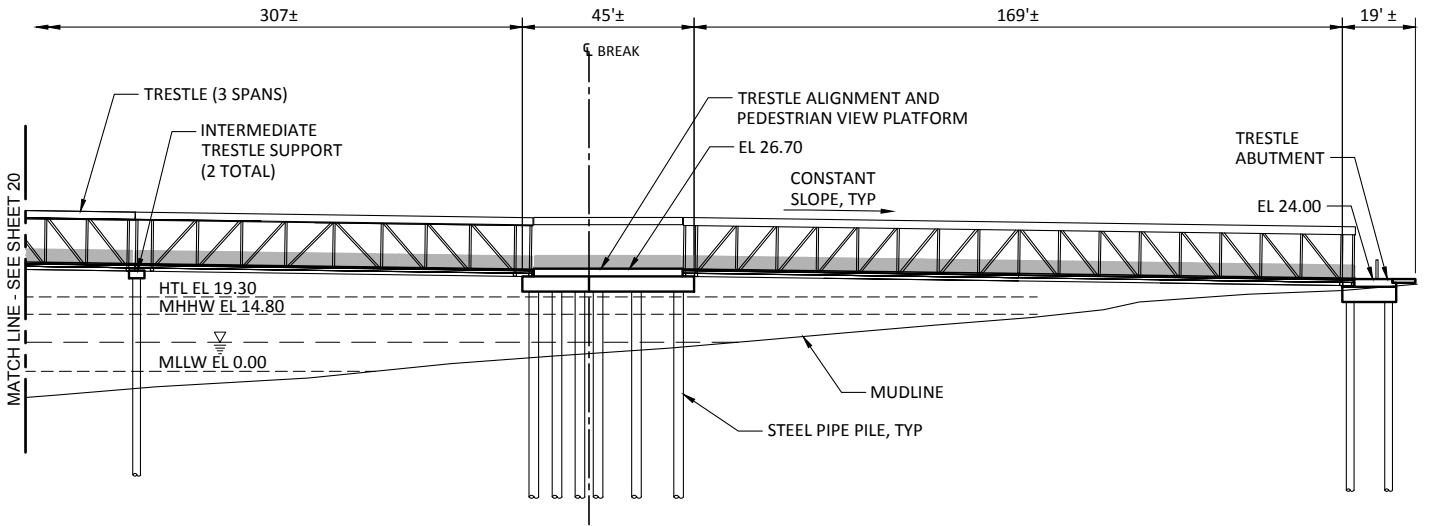
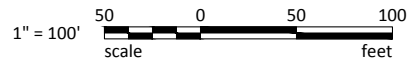

**ELEVATION - TRESTLE AND TRANSFER SPAN (SOUTH)**

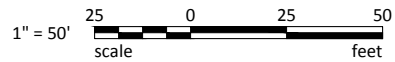

**PROPOSED PROJECT:**  
Proposed Hoonah Berthing Facility and Upland Improvements. Includes in-water and upland construction, upland demolition, and other activities.

**ADJACENT PROPERTY OWNERS:**

- 1) US Forest Service (Tongass)
- 2) City of Hoonah
- 3) Alaska Department of Natural Resources

**USACE REFERENCE NO:** NWS-POA-2012-0404

**APPLICANT:** Huna Totem Corporation

**LOCATION:** 108 Cannery Road, Hoonah, Alaska 99829

**LAT/LONG:** 58.1315306 / 135.465197

**IN:** Icy Strait & Port Frederick

**NEAR:** Hoonah, AK (1.5 miles NW)

**COUNTY:** Hoonah Angoon Borough

**STATE:** AK

## BERTHING FACILITY

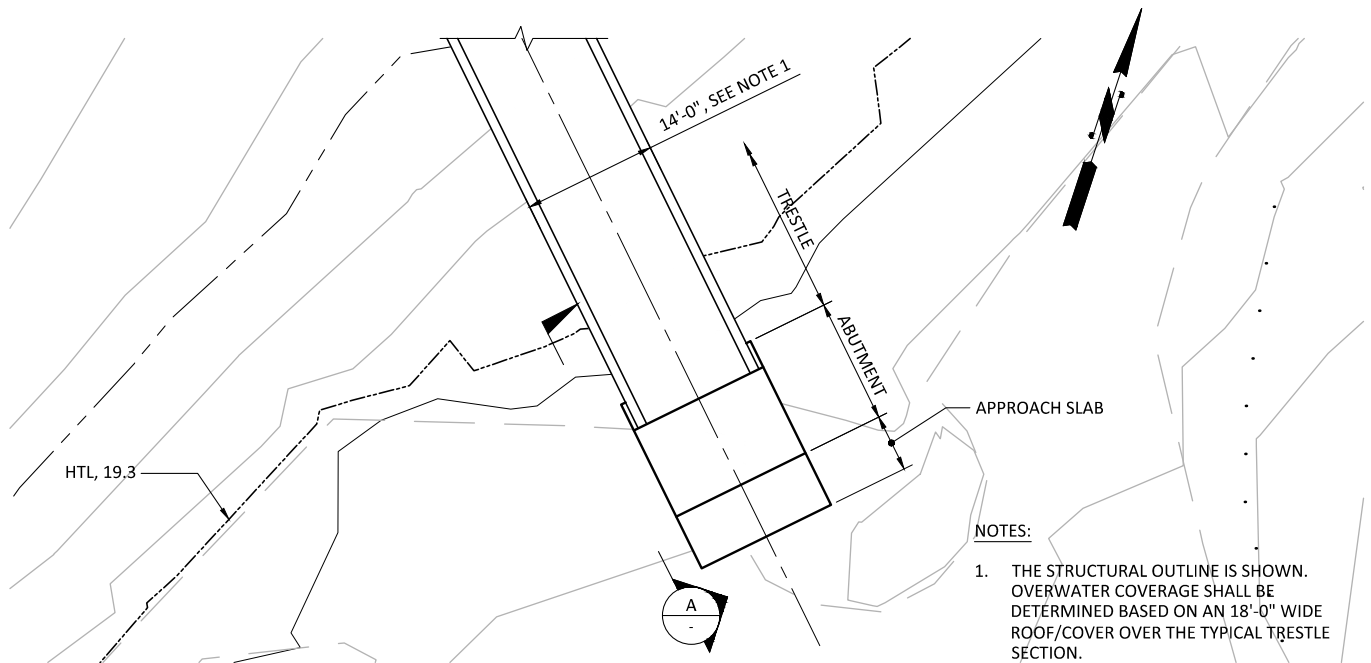

1  
19

## PLAN - TRESTLE ABUTMENT

1" = 20'

10 0 10 20

scale feet

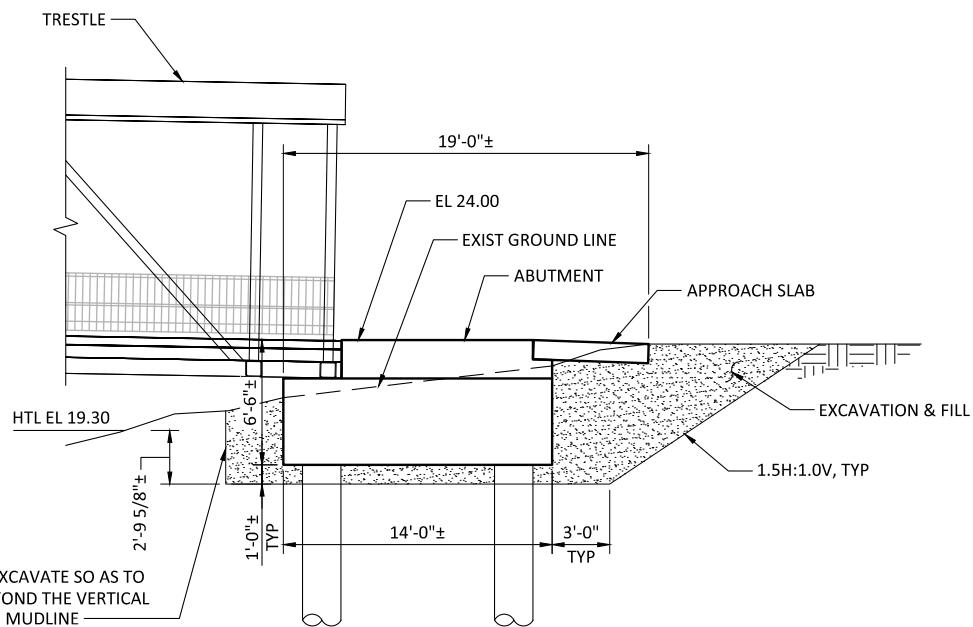

A

## SECTION - TRESTLE ABUTMENT

1" = 10'

5 0 5 10

scale feet

### PROPOSED PROJECT:

Proposed Hoonah Berthing Facility and Upland Improvements. Includes in-water and upland construction, upland demolition, and other activities.

### ADJACENT PROPERTY OWNERS:

- 1) US Forest Service (Tongass)
- 2) City of Hoonah
- 3) Alaska Department of Natural Resources

USACE REFERENCE NO: NWS-POA-2012-0404

APPLICANT: Huna Totem Corporation

LOCATION: 108 Cannery Road, Hoonah, Alaska 99829

LAT/LONG: 58.1315306 / 135.465197

IN: Icy Strait & Port Frederick

NEAR: Hoonah, AK (1.5 miles NW)

COUNTY: Hoonah Angoon Borough

STATE: AK

## TRESTLE ABUTMENT

Sheet 22 OF 24

Date: 8/4/14



**MITIGATION: SHORELINE DEBRIS REMOVAL**  
SCALE: NOT TO SCALE

**NOTE:**  
ESTIMATED WEIGHT OF MAN-MADE DEBRIS IS 1 TON.



|   |  |   |
|---|--|---|
| <p><b>PROPOSED PROJECT:</b><br/>Proposed Hoonah Berthing Facility and Upland Improvements. Includes in-water and upland construction, upland demolition, and other activities.</p> <p><b>ADJACENT PROPERTY OWNERS:</b></p> <ol style="list-style-type: none"><li>1) US Forest Service (Tongass)</li><li>2) City of Hoonah</li><li>3) Alaska Department of Natural Resources</li></ol> | <p><b>USACE REFERENCE NO:</b> NWS-POA-2012-0404</p> <p><b>APPLICANT:</b> Huna Totem Corporation</p> <p><b>LOCATION:</b> 108 Cannery Road, Hoonah, Alaska 99829</p> <p><b>LAT/LONG:</b> 58.1315306 / 135.465197</p> <p><b>IN:</b> Icy Strait &amp; Port Frederick</p> <p><b>NEAR:</b> Hoonah, AK (1.5 miles NW)</p> <p><b>COUNTY:</b> Hoonah Angoon Borough      <b>STATE:</b> AK</p> | <p><b>MITIGATION:</b><br/><b>SHORELINE DEBRIS REMOVAL</b></p> <p>Sheet 23 OF 24      Date: 8/4/14</p> |
|---|--|---|

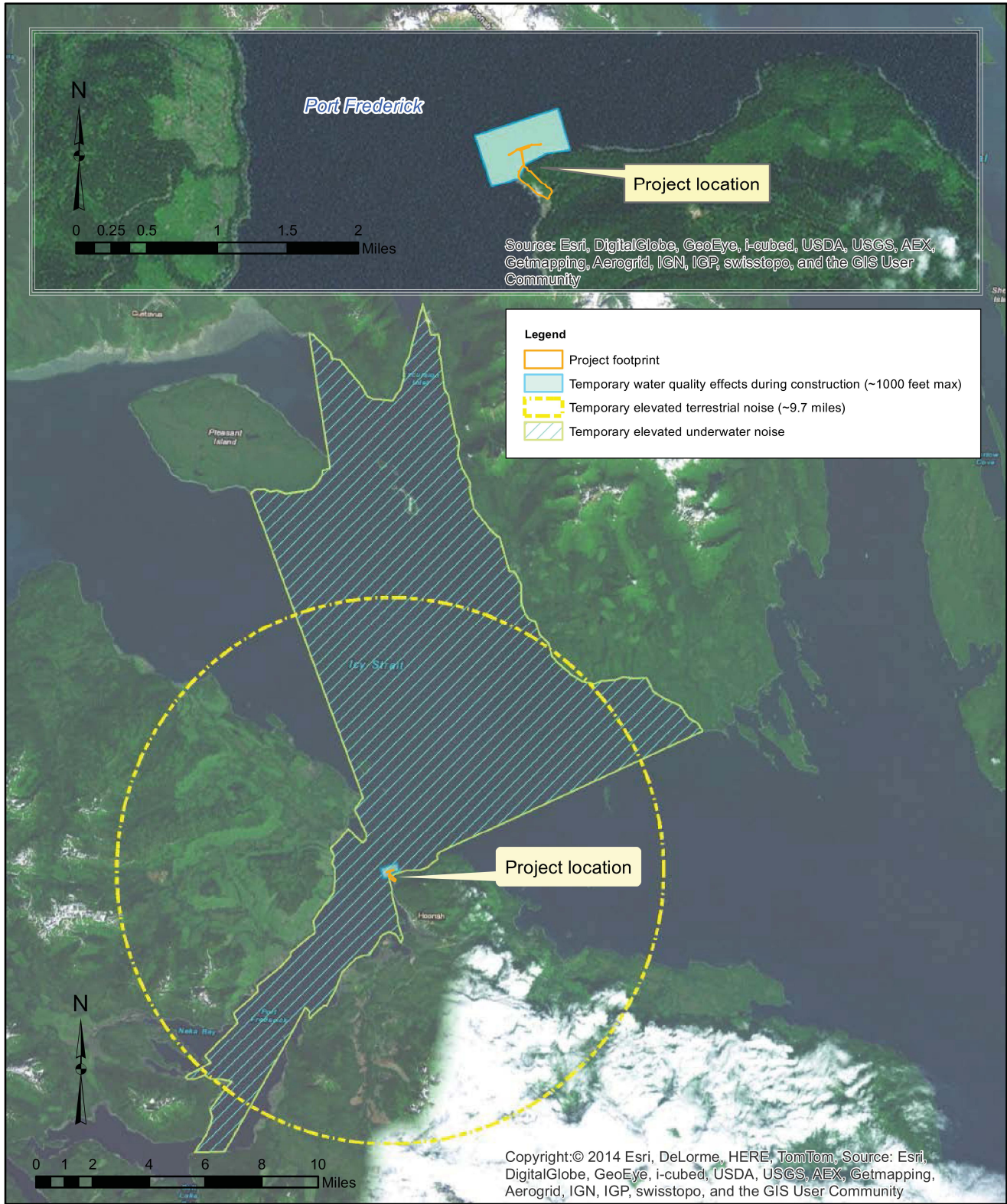

**PROPOSED PROJECT:**

Proposed Hoonah Berthing Facility and Upland Improvements. Includes in-water and upland construction, upland demolition, and other activities.

**ADJACENT PROPERTY OWNERS:**

- 1) US Forest Service (Tongass)
- 2) City of Hoonah
- 3) Alaska Department of Natural Resources

USACE REFERENCE NO: NWS-POA-2012-0404

APPLICANT: Huna Totem Corporation

LOCATION: 108 Cannery Road, Hoonah, Alaska 99829

LAT/LONG: 58.1315306 / 135.465197

IN: Icy Strait & Port Frederick

NEAR: Hoonah, AK (1.5 miles NW)

COUNTY: Hoonah Angoon Borough

STATE: AK

**ACTION AREA**